

**Elm Tree Close, Long Lee, Keighley, Yorkshire, BD21 4RX**  
**£575 Per Month**  
**Council Tax Band: A**



Open House Estate Agents are pleased to offer to let this newly refurbished one bedroom apartment in the popular area of Long Lee. This property benefits from been close to local amenities and near great transport links.

This property does have its own parking space to the rear of the property.

Council tax band- A

This property briefly comprises of;



Keighley

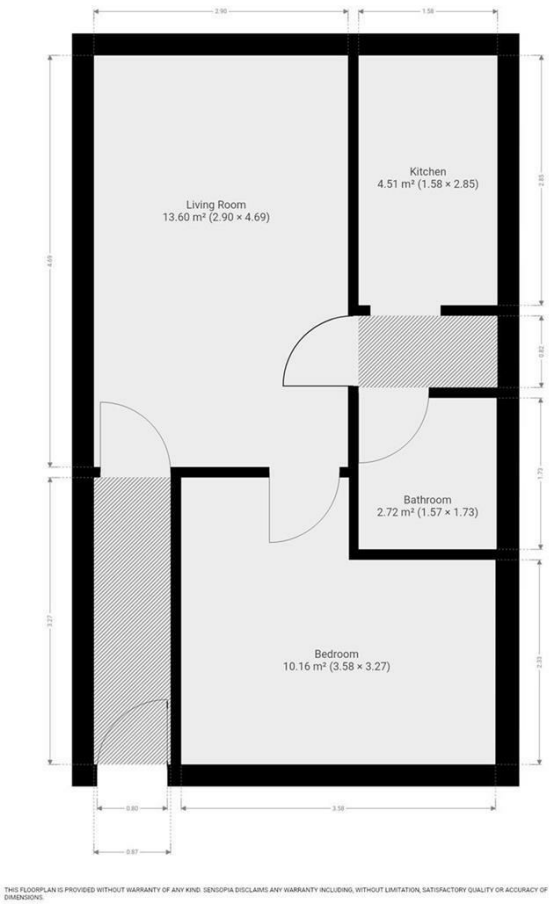

Energy Efficiency Rating		
	Current	Potential
Very energy efficient - lower running costs		
(92 plus) A		
(81-91) B		
(69-80) C		
(55-68) D	63	79
(39-54) E		
(21-38) F		
(1-20) G		
Not energy efficient - higher running costs		
England & Wales		
EU Directive 2002/91/EC		